

FESTIVAL FLEA MARKET SOUTH
NW 27TH AVE & NW 33RD STREET, POMPAHO BEACH, FL
LANDSCAPE PLAN

[illegible]

Sea

Lic. # LA666729
Member: A.S.L.A.

Drawing: Landscape Plan

Date: 11/05/2025

Scale: See Left

Drawn by: MAV

Sheet No.:

a Market for

For each of the 100 trials, the participant was presented with a stimulus consisting of a 100 ms duration of a 1000 Hz sine wave, followed by a 100 ms duration of a 1000 Hz sine wave with a phase shift of 180 degrees, followed by a 100 ms duration of a 1000 Hz sine wave with a phase shift of 0 degrees. The participant was then asked to judge whether the stimulus was a 1000 Hz sine wave or a 1000 Hz sine wave with a phase shift of 180 degrees. The participant's response was recorded and the trial was repeated 100 times. The participant's response was recorded and the trial was repeated 100 times.

Ref: 150000

L-5

Cad Id.: 2025-06

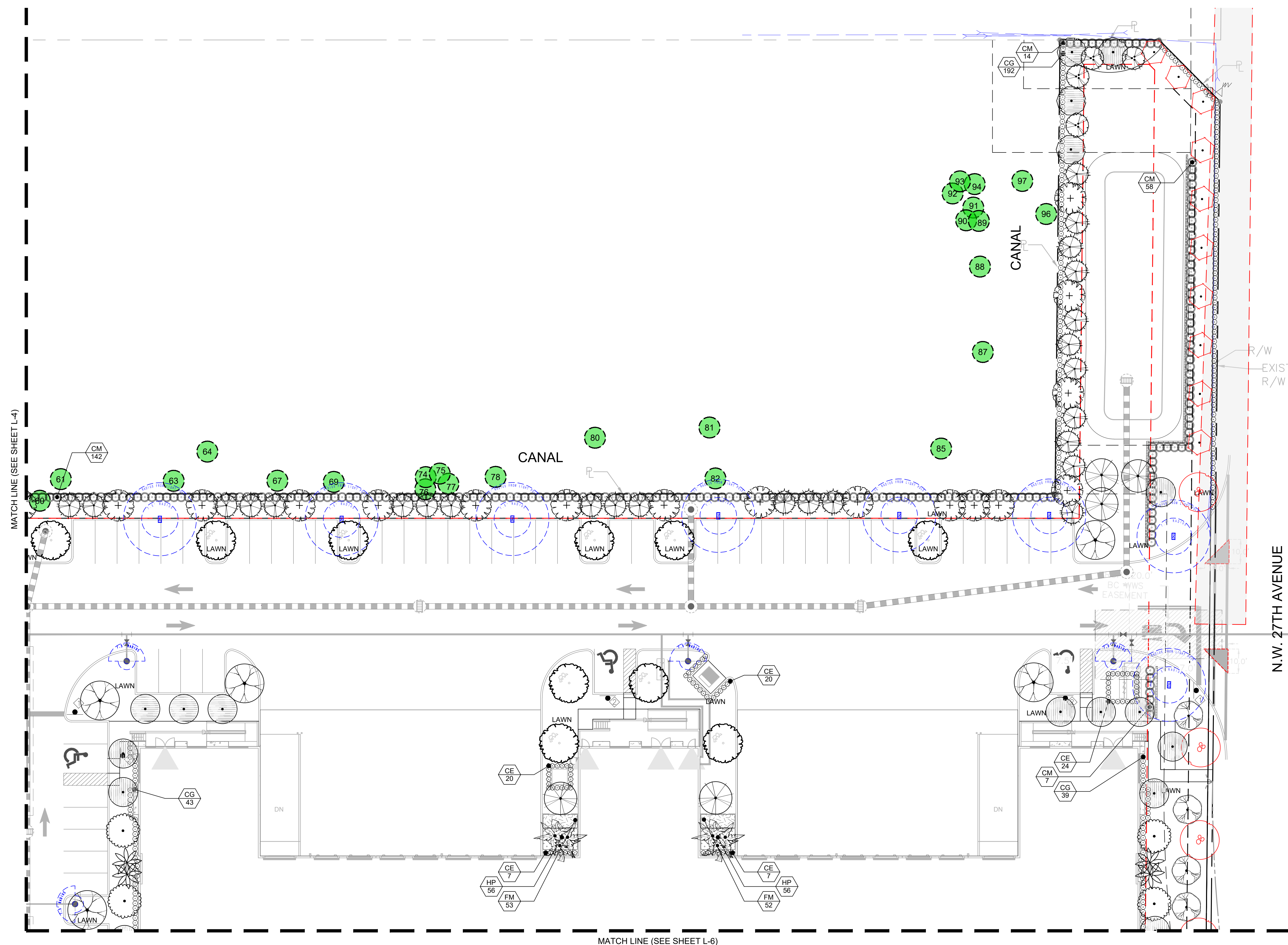

LANDSCAPE PLAN

Scale: 1" = 20'-0"



0' 20' 60' 120'

Note: Visibility and unobstructed working space must be maintained from fire apparatus access routes to fire protection and life safety appliances/equipment. The only landscaping should be grass or mulch no plants or shrubs. These include but not limited to: fire hydrants, fire department connections (FDC), post indicating valves (PIV), fire sprinkler risers, fire alarm control panels and electrical room locations require a minimum 36-inch clearance path to and on all sides. Fire hydrants require 36-inch clear space each side and rear with a 60-inch wide clear access from the fire apparatus access to fire hydrant. (NFPA 1-2021 Ch. 18 Sec. 18.5.7)

PROGRESS SET